

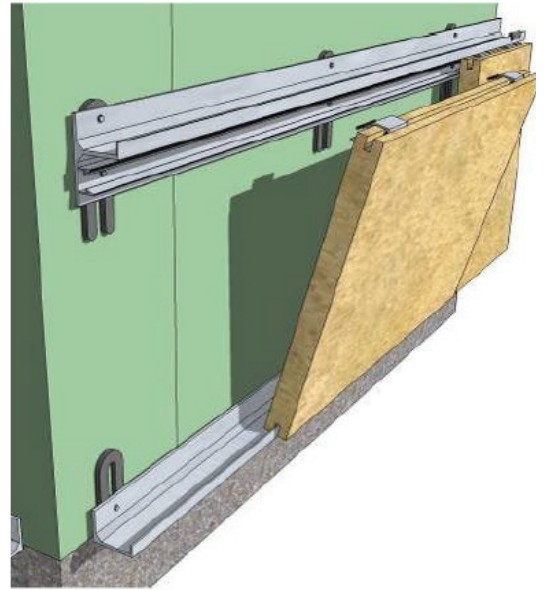

## Kirkland Cancer Center Jackson, TN

#01



This installation combined Fast Track's silver track hardware with almost 5,000 square foot of 1 1/2" thick RockCast architectural cast-stone panels from Reading Rock. The RockCast units came in three sizes:

12" x 24"

24" x 24", scored to simulate 12" x 24"

24" x 4", scored to simulate 4" x 4"

Architect:  
Davis-Stokes Collaborative, PC  
Brentwood, TN

General Contractor:  
Brasfield & Gorrie, LLC  
Nashville, TN

Masonry Contractor:  
Kelly Construction Co.  
Brentwood, TN